

MODUL 3

Eingriffswinkel 20°

A	B
50	30

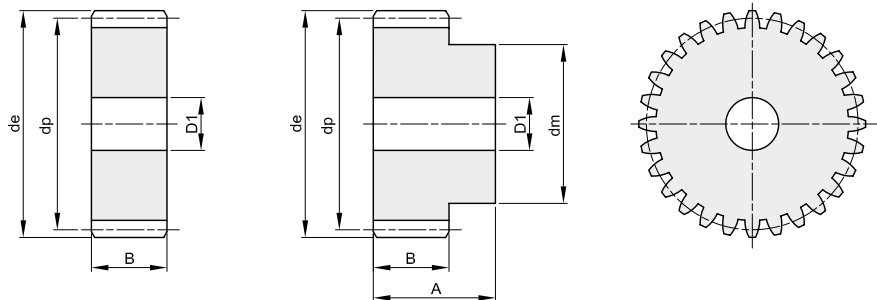

Werkstoff: Edelstahl 1.4305 // Verzahnung gerade // ab Zähnezahl 50 ohne Nabe

Z	Artikelnr.	de	dp	dm	D1	kg
12	403030012	42,0	36,0	27	12	0,28
15	403030015	51,0	45,0	35	12	0,47
20	403030020	66,0	60,0	45	14	0,84
24	403030024	78,0	72,0	50	16	1,18
25	403030025	81,0	75,0	60	16	1,39
30	403030030	96,0	90,0	60	16	1,85
40	403030040	126,0	120,0	80	20	3,31
50	403030050	156,0	150,0	–	20	4,06
60	403030060	186,0	180,0	–	20	5,89

MODUL 4

Eingriffswinkel 20°

A	B
60	40

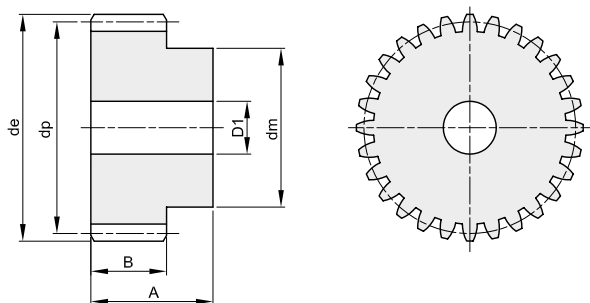

Werkstoff: Edelstahl 1.4305 // Verzahnung gerade

Z	Artikelnr.	de	dp	dm	D1	kg
12	403040012	56,0	48,0	35	14	0,63
13	403040013	60,0	52,0	40	14	0,78
14	403040014	64,0	56,0	45	14	0,93
15	403040015	68,0	60,0	45	14	1,05
20	403040020	88,0	80,0	60	16	1,90
25	403040025	108,0	100,0	75	20	2,98
30	403040030	128,0	120,0	75	20	4,06